

ANDHRA PRADESH STATE ROAD TRANSPORT CORPORATION

Amendment-II

for “Integrated Development of Bus Station, Tekkali
in Srikakulam District under BOT Scheme.”

Tender Notice No:04/CTM(C&P)/ BOT/2017-18 Dt. 05.10.2017

e-Tender ID : 146672.

With reference to the e-Tender Notice for “Integrated Development of Bus Station, Tekkali in Srikakulam District under BOT Scheme”, the intending **tenderers shall make note of the following changes.**

S.No	Description	As per Tender Schedule	As per Modified Schedule
1	Bid Security Amount in Lakh Rs.	17.06	20.17
2	Upfront Amount (in two equal installments) in Lakh Rs.	10.16	14.90
3	Annual Premium (Bid Parameter) in Lakh Rs.	8.46	13.20
4	Advance Annual Premium in Lakh Rs.	4.23	6.60
5	Project Development Fee in Lakh Rs.	8.53	10.09
6	Performance Bank Guarantee in Lakh Rs.	51.17	60.52
7	Construction Experience of Single project in last 3 years		
	a) Area of Construction in Sft	28428	NIL
	b) Value in Lakh Rs.	426.00	NIL
8	Construction Experience from not more than 5 projects in last 5 years		
	a) Area of Construction in Sft	56855	NIL
	b) Value in Lakh Rs.	853.00	NIL
9	Average Annual Turn over in the last 3 Financial Years 2013-14 to 2015-16 in Lakh Rs.	853.00	504.00
10	Net Worth in the last Financial Year 2015-16 in Lakh Rs.	426.00	252.00

11	Integrated Development of Bus Station Tekkali Development Plan		The revised drawing is enclosed in Annexure-I
12	Amended RFP		The bidders are requested to download the Amended RFP and follow the terms and conditions of Amended RFP only. They have to submit the signed copy of the amended RFP only to CTM (C&P) as per schedule.

The Bidders should sign all pages of Amendment –I and Amendment-II and upload the same in eprocurement platform before due date.

For further details please contact at Ph. Nos : 9100947839, 9959224535.

Dt. 15.11.2017

CTM(C&P)

REVISED LAYOUT PLAN

PRODUCED BY AN AUTODESK EDUCATIONAL PRODUCT

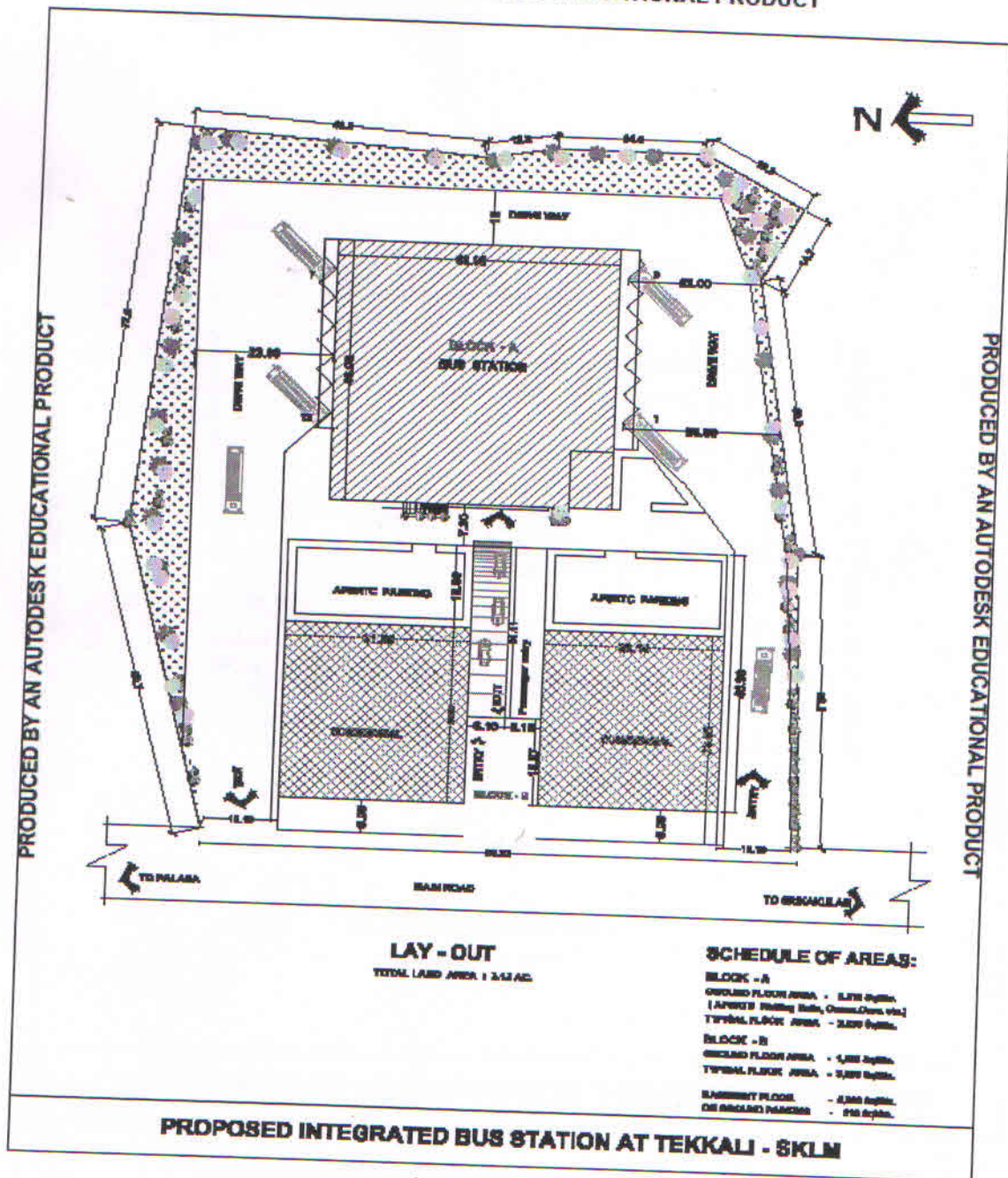

PRODUCED BY AN AUTODESK EDUCATIONAL PRODUCT

BUS STATION GROUND FLOOR PLAN

PRODUCED BY AN AUTODESK EDUCATIONAL PRODUCT

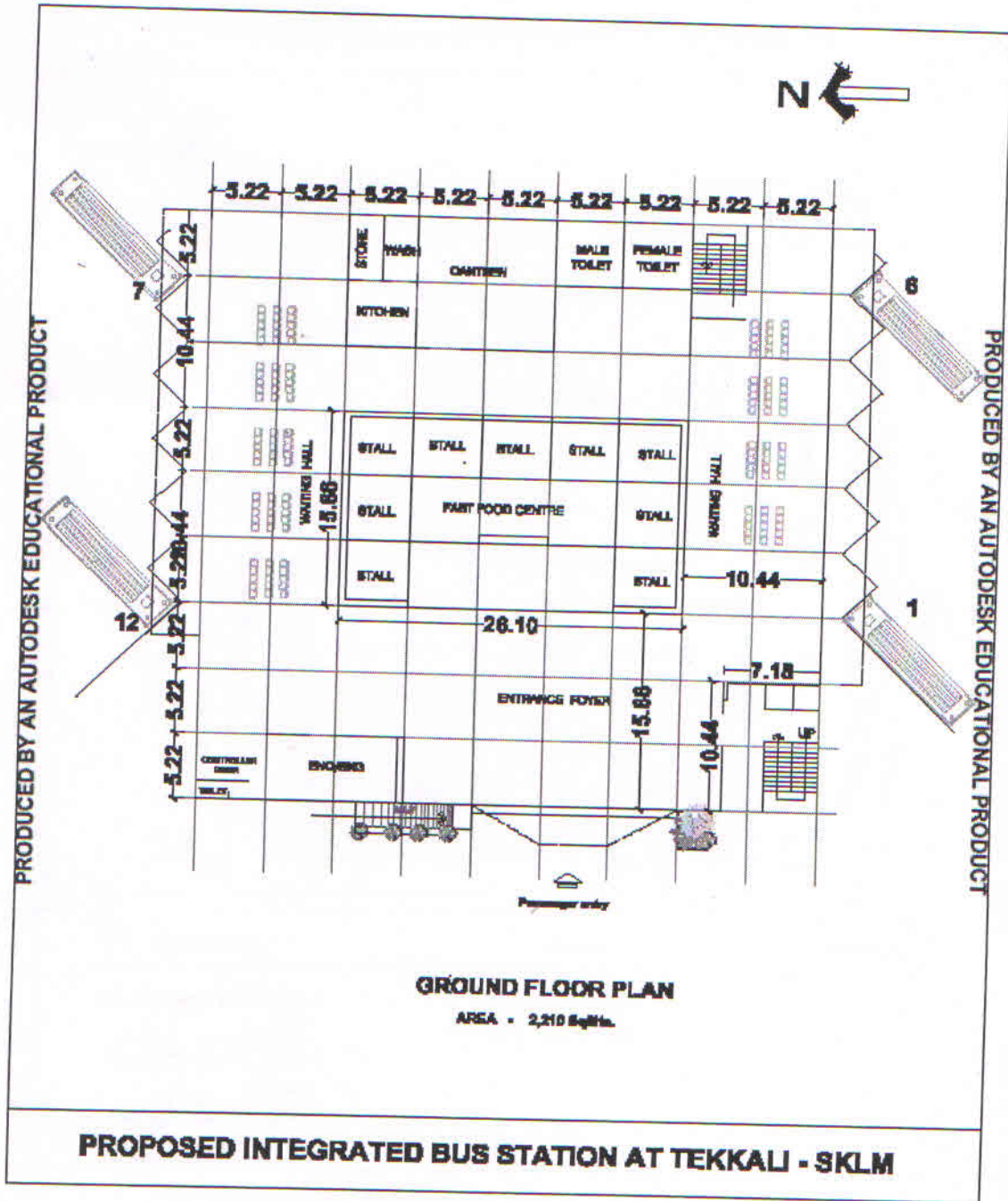

PRODUCED BY AN AUTODESK EDUCATIONAL PRODUCT